

RSF1031LC 1U Vented Shelf Installation

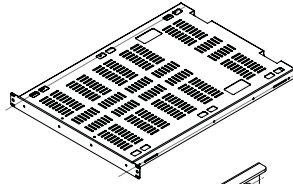

Included in this package

(1) RSF1031LC Shelf ❶



(8) M4 x 8 Screws



(2) Rear Mount Ear Brackets ❷

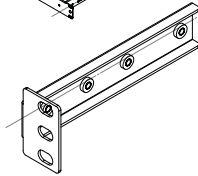

(4) #10-32 x 5/8 Rack Screws



(2) Extension Bar ❸

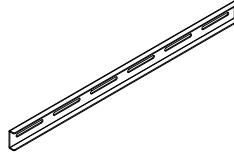

(4) #12-24 x 5/8 Rack Screws



Installation Steps

- (1) Place the main shelf ❶ unit on a flat surface.
- (2) Place the extension bar ❸ next to rear right side of the main shelf.
- (3) Align OB slot opening on the extension bar ❸ with screw holes on the main shelf. ❶
- (4) Secure extension bar with 1 to 2 M4 screws. Do not tighten them yet. (Figure 1)
- (5) Repeat step 2 to 4 for the left hand side.
- (6) Insert your main shelf ❶ into a rack. (You will need another person to help you to hold the rear end of main shelf.)
- (7) Align front ear bracket with mounting holes on the rack and secure them with rack screws on right and left side. (Do not tight them yet.)
- (8) Insert rear mount ear bracket ❷ into the channel on the extension bar ❸. (Figure 2)
- (9) Align rear mount ear bracket ❷ with the rack screw holes on the cabinet.
- (10) Adjust extension bar ❸ to align OB slot on the extension bar with mounting screw holes on the rear mount ear bracket ❷.
- (11) Secure extension bar ❸ with 1 to 2 M4 screws.
- (12) Repeat step 8 to 11 for other side.
- (13) Readjust your main shelf then tighten all M4 screws.
- (14) Installation complete.

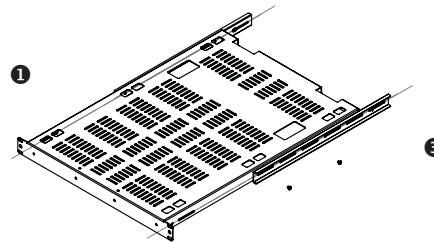

Figure 1

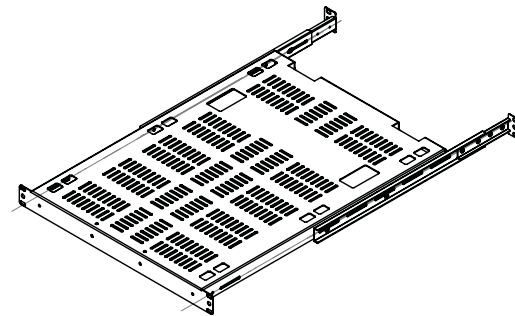

Figure 2